

1. MATERIAL:
COVER: COPPER ALLOY
LIGHT PIPE: POLYCARBONATE (94-V0 RATED)
2. THIS LIGHT PIPE ASSEMBLY IS TO BE USED WITH THE SFP+ 1X4 CAGE ASSEMBLY P/N 747540224
3. IT IS RECOMMENDED THAT THE CAGE BE PRESSED INTO OR SOLDERED TO THE PCB PRIOR TO ASSEMBLING THE LIGHT PIPE ASSEMBLY.
4. THIS PART MEETS THE RESTRICTION OF HAZARDOUS SUBSTANCES IN ELECTRICAL AND ELECTRONIC EQUIPMENT (RoHS) DIRECTIVE (2002/95/EC)

RELEASED IEC NO. USY2009-0596 DRAWN BY: JRESENDE 2009/08/26 CHECKED BY: CHYKD 2009/08/26 APPR.: JRESENDE 2009/08/26 REV:	QUALITY SYMBOLS	GENERAL TOLERANCES (UNLESS SPECIFIED)	DIMENSION STYLE	SCALE	DESIGN UNITS	THIRD ANGLE PROJECTION
	▽=0 ▽=0	mm INCH 4 PLACES ± --- ± --- 3 PLACES ± --- ± --- 2 PLACES ± 0.15 ± --- 1 PLACE ± 0.25 ± --- ANGULAR ± 1°	MM ONLY	4:1	METRIC	
	DESCRIPTION	DRAFT WHERE APPLICABLE MUST REMAIN WITHIN DIMENSIONS	DRAWN BY: JRESENDE 2009/6/19	DATE: 2009/6/19	TITLE: SFP+ 1X2 PCI LIGHT PIPE COVER ASSY, ULTRA LOW PROFILE, BACK TOP	
	MATERIAL NO. 747540024	DATE: 2009/6/19	CHECKED BY: JRESENDE 2009/6/19	DATE: 2009/6/19	APPROVED BY: KJANOTA 2009/6/19	
		MOLEX INCORPORATED		DOCUMENT NO. SD-74754-0024		SHEET NO. 1 OF 2

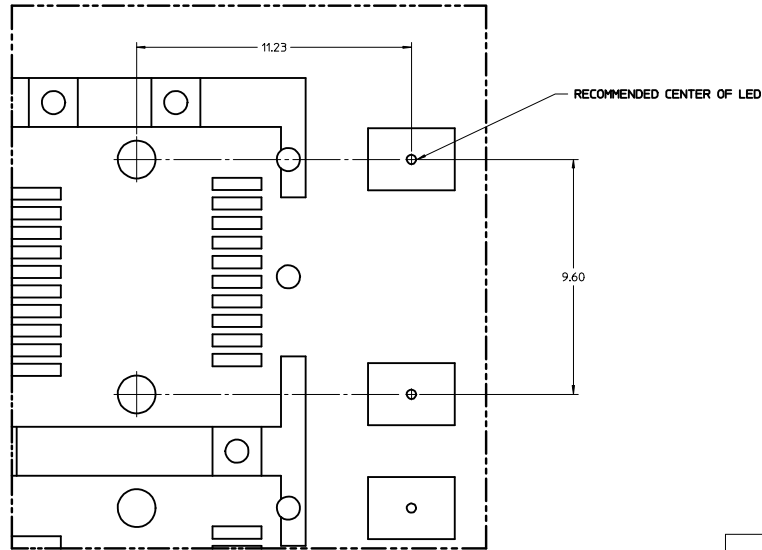
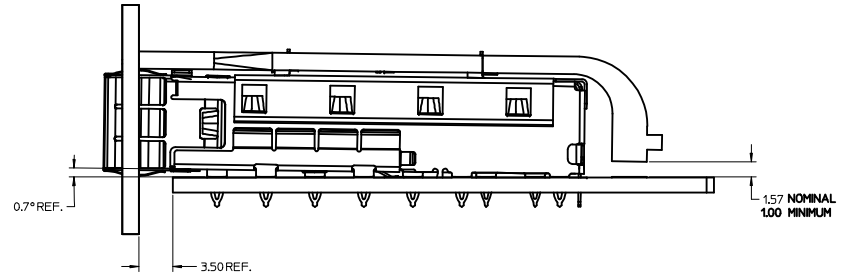
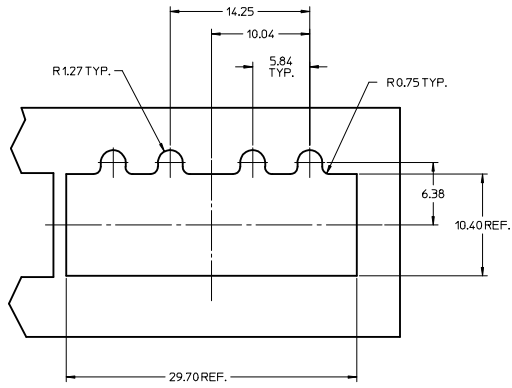

HOST PCB LAYOUT (SCALE 10:1)
 1. LED SHOULD BE PLACED RELATIVE TO THE SFP CONNECTOR POST HOLES
 2. LAYOUT APPLIES TO EACH PORT

RELEASED IEC NO. USY2009-0596 DRAWN: JRESENDE 2009/08/26 CHYK: 2009/08/26 APPR: JRESENDE 2009/08/26 REV:	QUALITY SYMBOLS	GENERAL TOLERANCES (UNLESS SPECIFIED)	DIMENSION STYLE	SCALE	DESIGN UNITS	THIRD ANGLE PROJECTION															
	$\nabla=0$ $\nabla=0$	<table border="1"> <thead> <tr> <th></th> <th>mm</th> <th>INCH</th> </tr> </thead> <tbody> <tr> <td>4 PLACES</td> <td>±---</td> <td>±---</td> </tr> <tr> <td>3 PLACES</td> <td>±---</td> <td>±---</td> </tr> <tr> <td>2 PLACES</td> <td>±0.15</td> <td>±---</td> </tr> <tr> <td>1 PLACE</td> <td>±0.25</td> <td>±---</td> </tr> </tbody> </table>		mm	INCH	4 PLACES	±---	±---	3 PLACES	±---	±---	2 PLACES	±0.15	±---	1 PLACE	±0.25	±---	MM ONLY	3:1	METRIC	
		mm	INCH																		
	4 PLACES	±---	±---																		
3 PLACES	±---	±---																			
2 PLACES	±0.15	±---																			
1 PLACE	±0.25	±---																			
DESCRIPTION	DRAFT WHERE APPLICABLE MUST REMAIN WITHIN DIMENSIONS	<table border="1"> <thead> <tr> <th>DRAWN BY</th> <th>DATE</th> <th>TITLE</th> </tr> </thead> <tbody> <tr> <td>JRESENDE</td> <td>2009/6/19</td> <td>SFP+ 1X2 PCI LIGHT PIPE COVER ASSY, ULTRA LOW PROFILE, BACK TOP</td> </tr> <tr> <td>JRESENDE</td> <td>2009/6/19</td> <td></td> </tr> <tr> <td>KJANOTA</td> <td>2009/6/19</td> <td></td> </tr> </tbody> </table>	DRAWN BY	DATE	TITLE	JRESENDE	2009/6/19	SFP+ 1X2 PCI LIGHT PIPE COVER ASSY, ULTRA LOW PROFILE, BACK TOP	JRESENDE	2009/6/19		KJANOTA	2009/6/19								
DRAWN BY	DATE	TITLE																			
JRESENDE	2009/6/19	SFP+ 1X2 PCI LIGHT PIPE COVER ASSY, ULTRA LOW PROFILE, BACK TOP																			
JRESENDE	2009/6/19																				
KJANOTA	2009/6/19																				
			MATERIAL NO. 747540024 SIZE D		DOCUMENT NO. SD-74754-0024	SHEET NO. 2 OF 2															